

NG2



FEATURES

A two-stage compensated membrane pressure regulator with a water/gas heat exchanger, filter, high pressure gas solenoid valve and safety valve. Calibrated for a delivery pressure of 2 bar (200 kPa) higher than the pressure present in the aspiration ducts. Its rated capacity is 40 kg/h.

VERSIONS

NG2-2 with manometer and level sensor

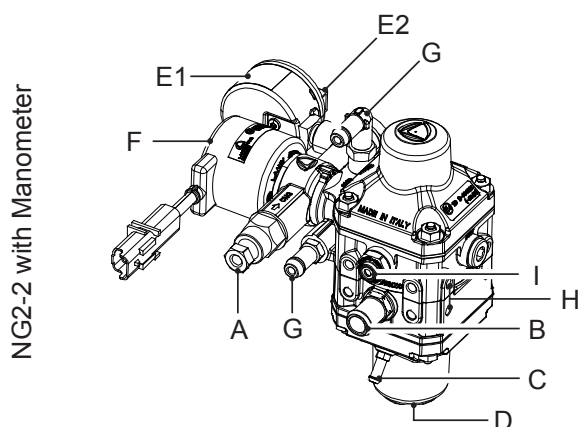

- A. Gas inlet connector
- B. Gas outlet connector
- C. Depression / compensation fitting pressure manifolds
- D. Pressure Adjustment 2° stage
- E1. Manometer
- E2. Pressure sensor with level indicator
- F. High Pressure Valve
- G. Fittings reducer heating circuit
- H. Fixing points pressure regulator
- I. Safety valve

MAINTENANCE

- Control of the pressure regulator pressure at 20.000 km
- Control tightness of the gas line connectors and heating at 20.000 km
- Revision of the pressure regulator (replacement of membranes and gaskets) at 80.000 km
- Gas filter (high pressure) at 80.000 km

HOMOLOGATIONS

- E4 110R-000022 + E3 10R-036366
- E3 110R-006072 + E3 10R-036392

TECHNICAL SPECIFICATIONS

VERSION	NG2
Type	two-stage compensated membrane
Dimension	169x134x174 mm
Weight	2,1 kg
Operation Nominal flow	40/50 kg/h CNG
Operating temperature	-40°C / 120°C
Safety valve calibration pressure	18 bar
Work pressure Relative	2 bar
EV electric coil Features	12 V - 20 W
Supply voltage	Nominale 12 V (8 ÷ 16 V)
Gas inlet connector	Ø 6 mm - M12x1 mm
Gas outlet connector	Ø 14 mm
Heating liquid Fittings	Ø 10 mm
Connectors vacuum / pressure	Ø 5 mm