

NG1



FEATURES

The NG1 is a single-stage compensated membrane reducer with a water/gas heat exchanger, filter, high pressure gas solenoid valve and safety valve. Calibrated for a delivery pressure of 2 bar (200 kPa) higher than the pressure present in the aspiration ducts. Its maximum capacity is 25 kg/h.

VERSIONS

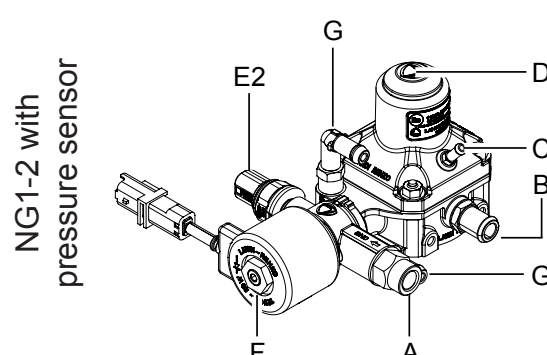
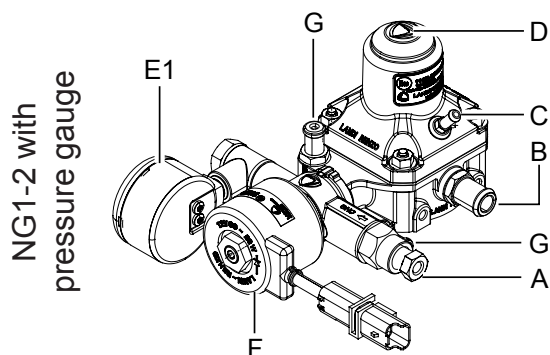

- A. Gas inlet connector
- B. Gas outlet connector
- C. Depression / compensation fitting pressure manifolds
- D. Pressure Adjustment
- E1. Manometer

- E2. Pressure sensor with level indicator
- F. High Pressure Valve
- G. Fittings reducer heating circuit
- H. Fixing points pressure regulator
- I. Safety valve

MAINTENANCE

- Control of the pressure regulator pressure at 20.000 km
- Control tightness of the gas line connectors and heating at 20.000 km
- Revision of the pressure regulator (replacement of membranes and gaskets) at 80.000 km
- Gas filter (high pressure) at 80.000 km

HOMOLOGATIONS

- E13 110R-000098
- E3 110R-006072
- E3 10R-036366

TECHNICAL SPECIFICATIONS

VERSION	NG1
Type	single-stage membrane
Dimension	165x100x130 mm
Weight	1,7 kg
Operation Nominal flow	25 kg/h CNG
Operating temperature	-40°C / 120°C
Safety valve calibration pressure	3,2/4 bar
Work pressure Relative	2 bar
EV electric coil Features	12 V - 20 W
Supply voltage	12 V (8 ÷ 16 V)
Gas inlet connector	Ø 6 mm
Gas outlet connector	Ø 14 mm
Heating liquid Fittings	Ø 10 mm
Connectors vacuum / pressure	Ø 5 mm