

# NG2



## FEATURES

A two-stage compensated membrane pressure regulator with a water/gas heat exchanger, filter, high pressure gas solenoid valve and safety valve. Calibrated for a delivery pressure of 2 bar (200 kPa) higher than the pressure present in the aspiration ducts. Its rated capacity is 40 kg/h.

## VERSIONS

### NG2-2 with manometer and level sensor

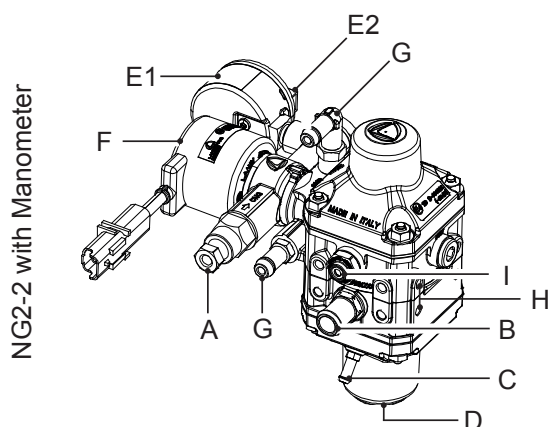

- A. Gas inlet connector
- B. Gas outlet connector
- C. Depression / compensation fitting pressure manifolds
- D. Pressure Adjustment 2° stage
- E1. Manometer
- E2. Pressure sensor with level indicator
- F. High Pressure Valve
- G. Fittings reducer heating circuit
- H. Fixing points pressure regulator
- I. Safety valve

## MAINTENANCE

Control of the pressure regulator pressure at 20.000 km

Control tightness of the gas line connectors and heating at 20.000 km

Revision of the pressure regulator (replacement of membranes and gaskets) at 80.000 km

Gas filter (high pressure) at 80.000 km

## HOMOLOGATIONS

E13 110R-000098

E3 110R-006072

E3 10R-036366

**TECHNICAL SPECIFICATIONS**

VERSION	NG2
Type	two-stage compensated membrane
Dimension	189x177x143 mm
Weight	2,1 kg
Operation Nominal flow	40/50 kg/h CNG
Operating temperature	-40°C / 120°C
Safety valve calibration pressure	18 bar
Work pressure Relative	2 bar
EV electric coil Features	12 V - 20 W
Supply voltage	Nominale 12 V (8 ÷ 16 V)
Gas inlet connector	Ø 6 mm - M12x1 mm
Gas outlet connector	Ø 14 mm
Heating liquid Fittings	Ø 10 mm
Connectors vacuum / pressure	Ø 5 mm

